

# Lugus HOMES



## Burridge Gardens, Clapham Junction

Prices from £550,000



This beautifully designed fifth-floor one-bedroom apartment extends to approximately 553 sq ft and enjoys peaceful courtyard views.

Forming part of One Clapham Junction, a premium residential development, the apartment is ideally located just moments from Clapham Junction Station and the River Thames, perfectly positioned between the green open spaces of Clapham Common and Wandsworth Common.

Residents benefit from an exceptional range of on-site amenities, including a 24-hour concierge, landscaped courtyard gardens, and a fully equipped fitness suite featuring Peloton facilities.

Developed by Mount Anvil, One Clapham Junction offers outstanding connectivity. Clapham Junction Station provides swift access to London Victoria (approximately 6 minutes), along with direct links to Waterloo, Canary Wharf, King's Cross, and Gatwick Airport. Wimbledon and Richmond are also just two stops away.

The surrounding area boasts an excellent selection of restaurants, cafés, and independent boutiques, with the vibrant Northcote Road just around the corner, renowned for its popular bars, eateries, and weekend



# Area Map

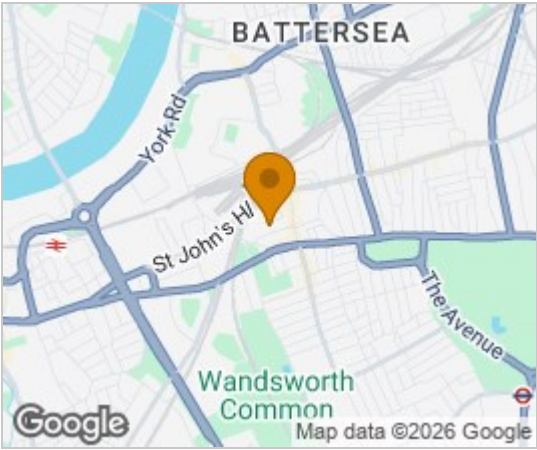

# Floor Plans

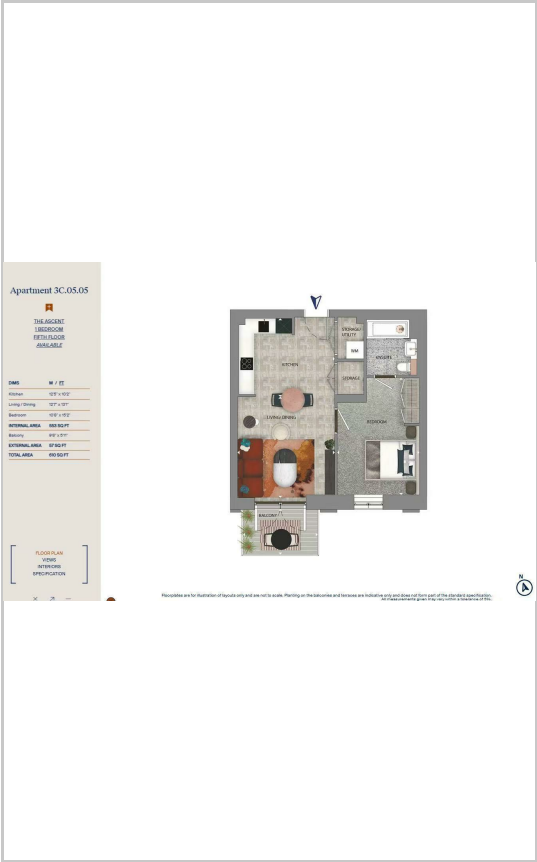

# Energy Efficiency Graph

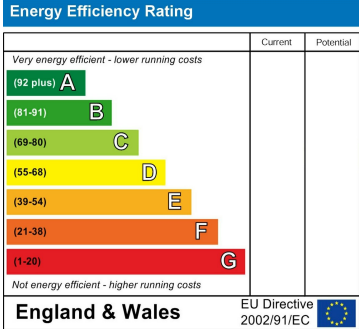

These particulars, whilst believed to be accurate are set out as a general outline only for guidance and do not constitute any part of an offer or contract. Intending purchasers should not rely on them as statements of representation of fact, but must satisfy themselves by inspection or otherwise as to their accuracy. No person in this firms employment has the authority to make or give any representation or warranty in respect of the property.